

# SITE PLANS



CANTON WATERFRONT **P**

WATERFRONT PUBLIC PAID PARKING LOT  
APPROX 650 SPACES

UPPER LEVEL

9,802 AAWDT

S CLINTON ST

GROUND LEVEL

SIGNAGE PYLON



CareFirst **+**  
214,000 SF  
~200 employees

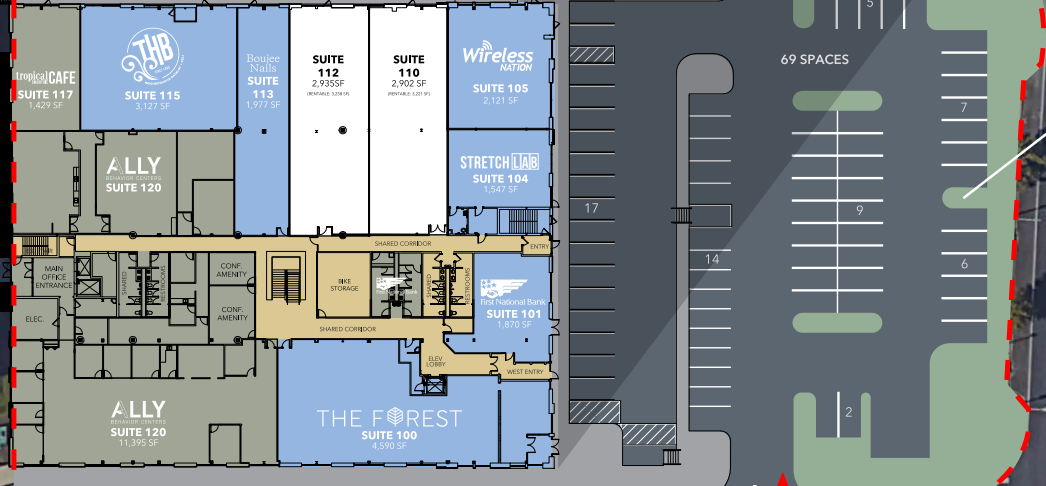

BOSTON ST 18,790 AAWDT

S HIGHLAND AVE

**P**

PARKING GARAGE  
134 SPACES

merritt clubs

BAYLIS ST

Site Plan Key

- Leased
- Available
- At Lease
- At LOI
- Open

0 90 FEET

ULTA FIVE BEL'W LOFT DSW