

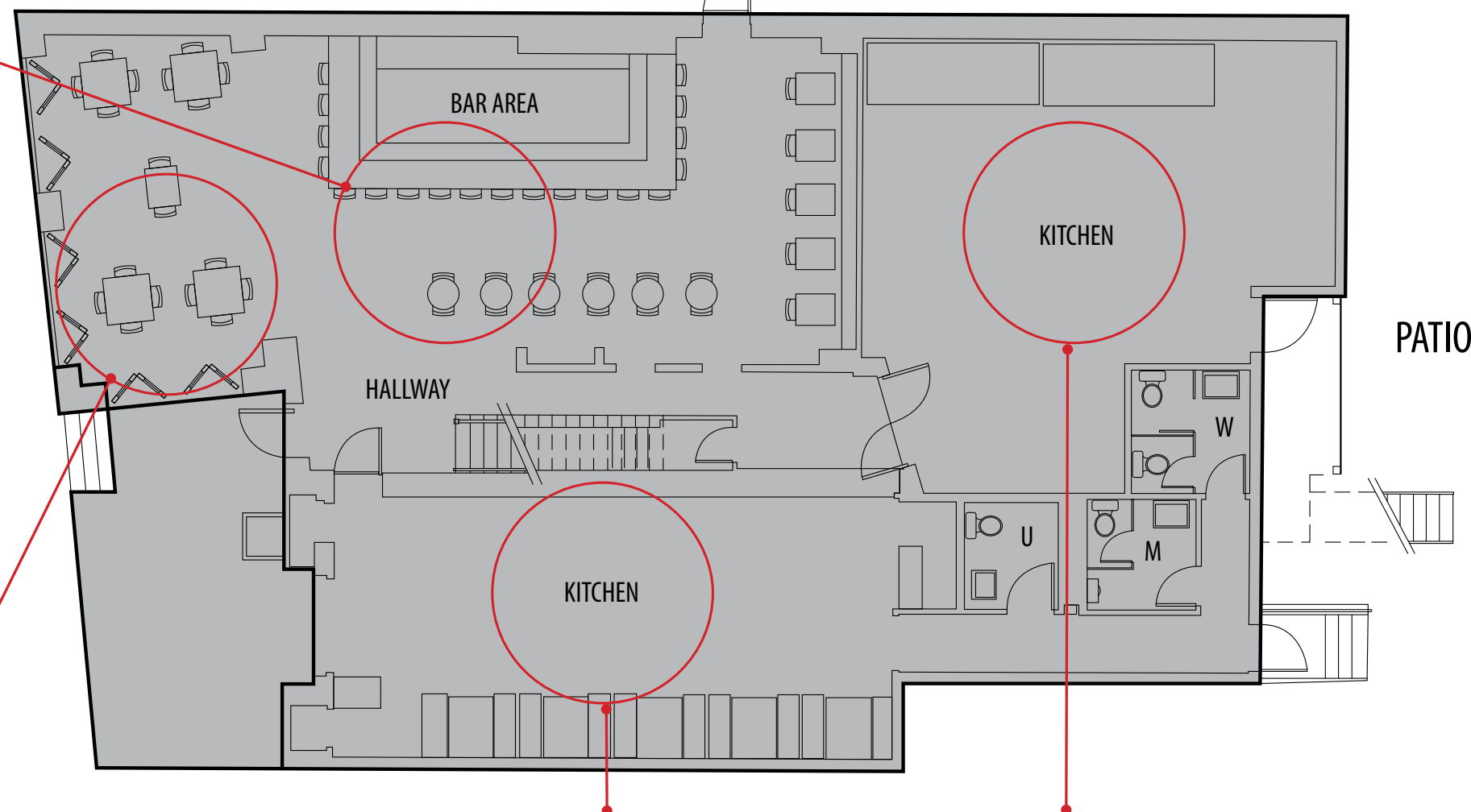

FIRST FLOOR | 3,366 SF BLDG | 305 SF DECK



HR
RETAIL
A MEMBER OF CHARLINGS RETAIL ADVISORS

2340
WISCONSIN AVE, NW
GLOVER PARK, DC



SECOND FLOOR | 2,455 SF BLDG | 567 SF DECK



2340
WISCONSIN AVE, NW
GLOVER PARK, DC

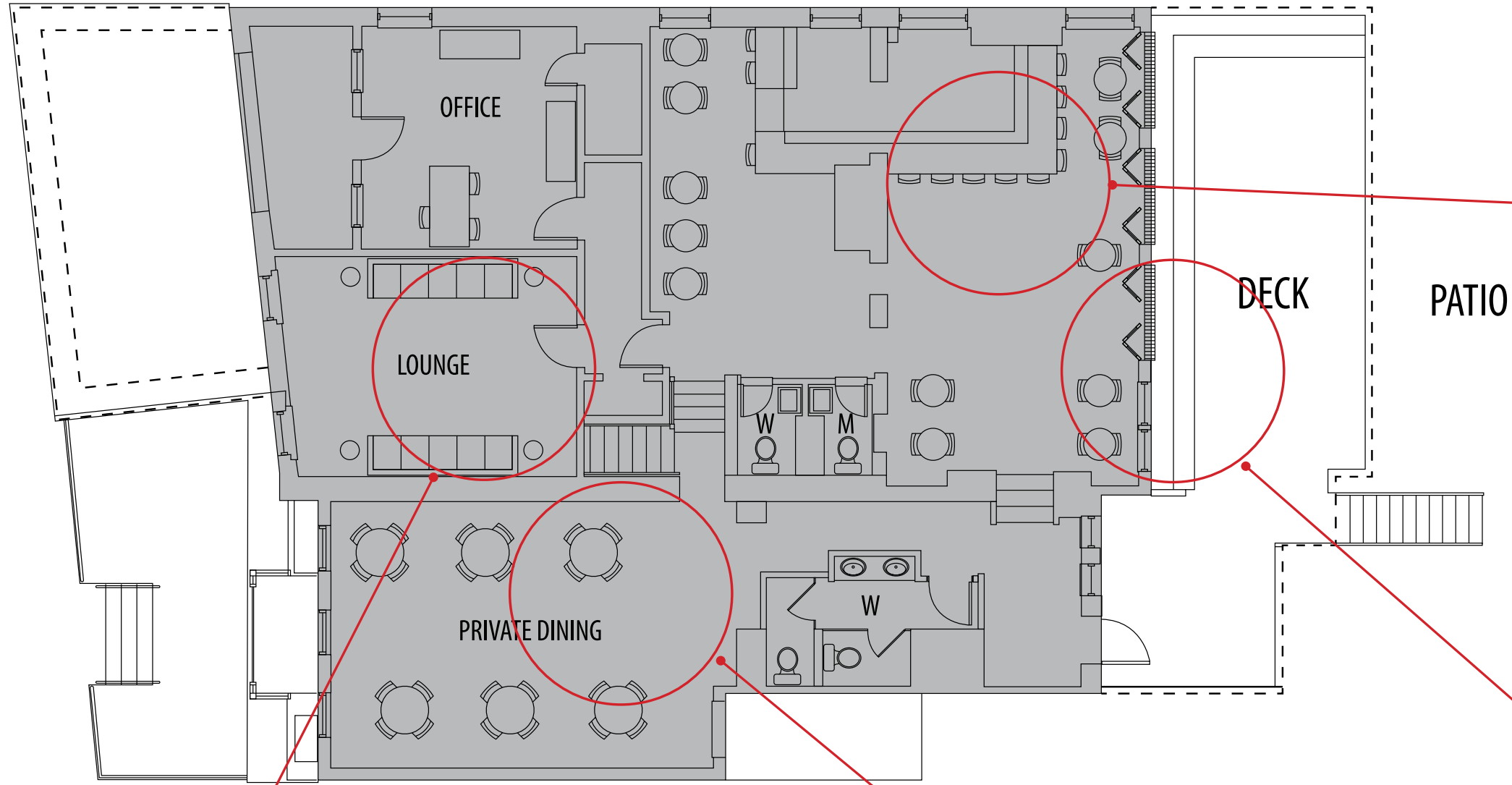

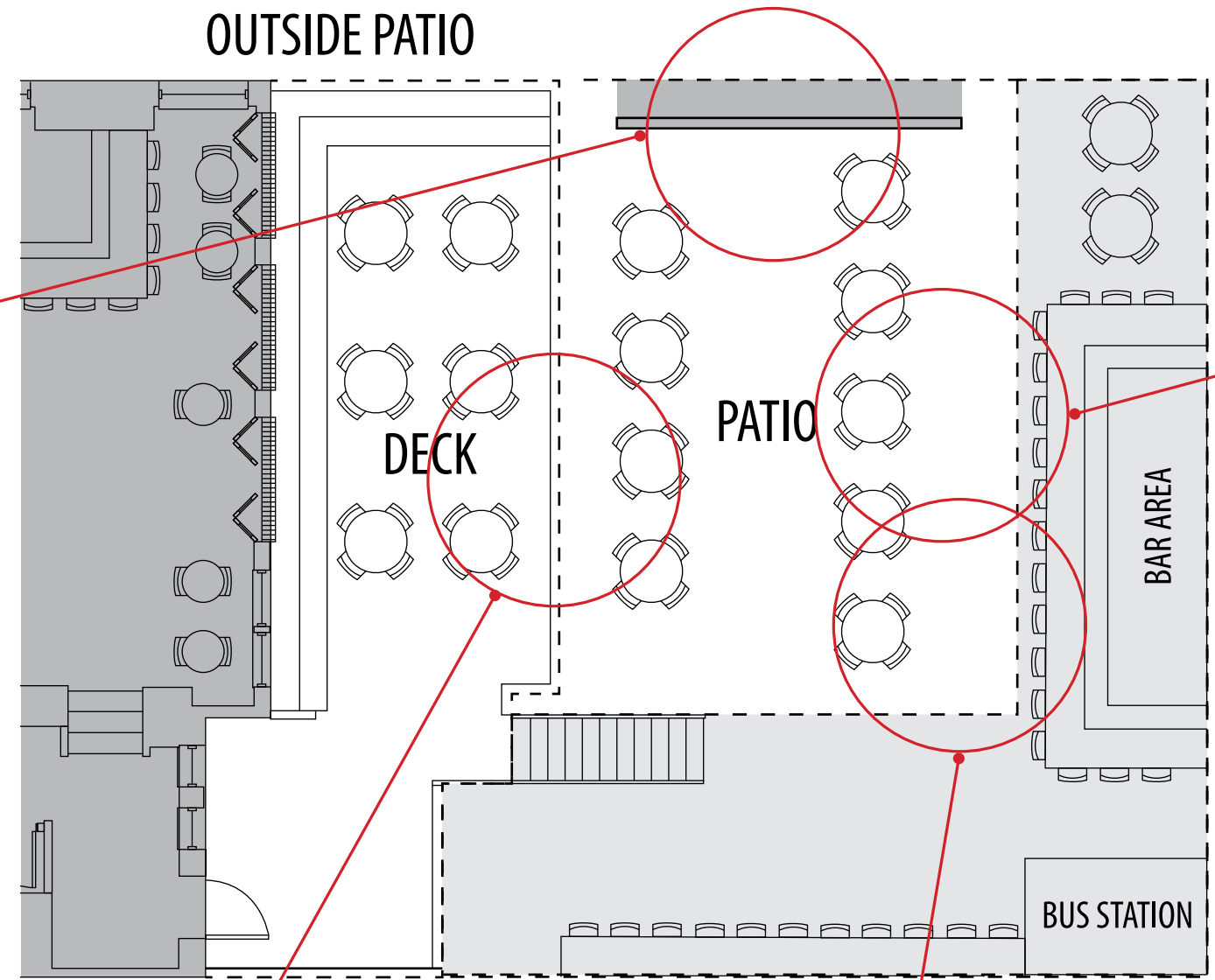

2340
WISCONSIN AVE, NW
GLOVER PARK, DC

